

MELBOURNE



CLASS C MOTORHOME

MELBOURNE • MELBOURNE PRESTIGE



COMPACT COMFORT AND LUXURY

2+3
YEAR | YEAR
WARRANTY

MELBOURNE



Melbourne 24L Shown in Huntington Interior Design

Scan QR code to view Melbourne on web



Scan QR code to view 360° tours



Ext. Lgth: 25' 2" Wheelbase: 170" GVWR: 11,030 lbs.

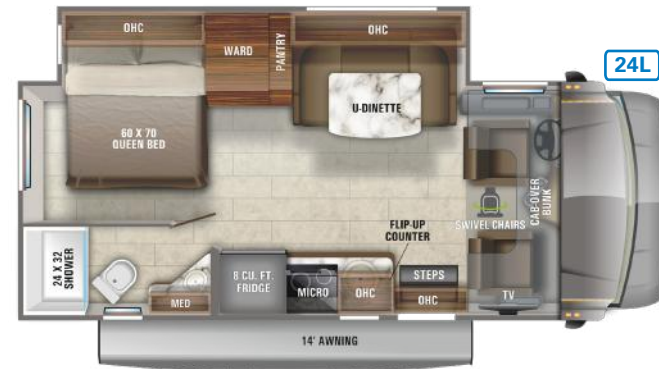

Ext. Lgth: 25' 2" Wheelbase: 170" GVWR: 11,030 lbs.

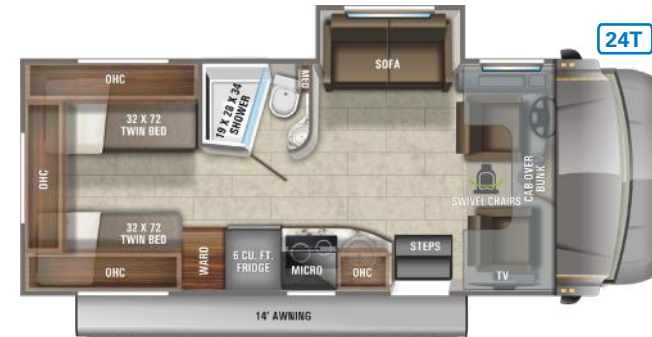

Ext. Lgth: 25' 2" Wheelbase: 170" GVWR: 11,030 lbs.



TOP FEATURES

Scan QR code for more information



- Mercedes-Benz® 3500 chassis with 170 in. wheelbase
- V-6 Turbo 188 HP diesel engine with electronic fuel injection and 325 ft.-lb. torque
- One-piece, seamless, fiberglass front cap
- 13,500 BTU A/C
- Electric patio awning with LED lights
- Frameless windows
- Backup and side-view cameras
- Sony® infotainment center with Apple® CarPlay™ and Android Auto™
- Swivel driver and passenger seats
- Hardwood cabinet doors and drawers
- LED-lit fascia
- 8 cu. ft. gas/electric refrigerator

HUNTINGTON



STANDARD GRAPHICS



PINEHURST FULL-BODY PAINT



MUIRFIELD FULL-BODY PAINT



WATERVILLE FULL-BODY PAINT

MELBOURNE PRESTIGE



Scan QR code to view 360° tours

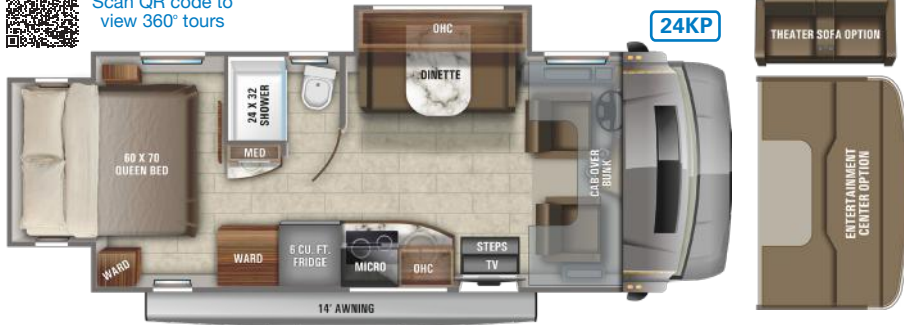

Ext. Lgth: 25' 2" Wheelbase: 170" GVWR: 11,030 lbs.

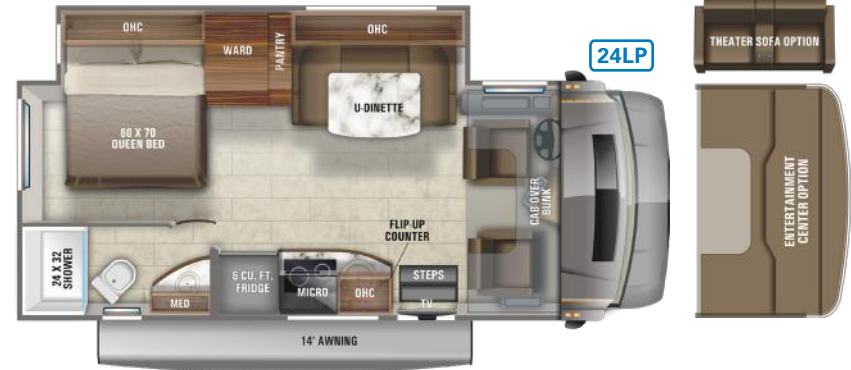

Ext. Lgth: 25' 2" Wheelbase: 170" GVWR: 11,030 lbs.

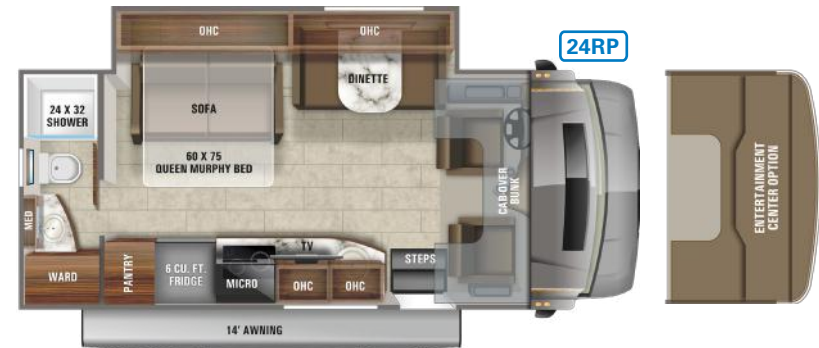

Ext. Lgth: 25' 2" Wheelbase: 170" GVWR: 11,030 lbs.

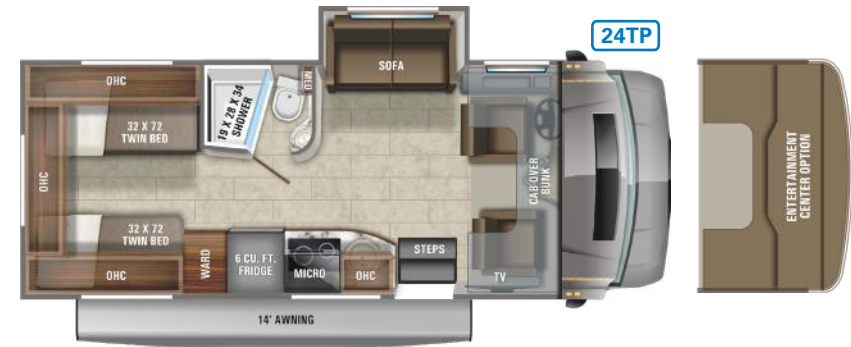

Ext. Lgth: 25' 2" Wheelbase: 170" GVWR: 11,030 lbs.

TOP FEATURES

Scan QR code for more information



- Upgraded Mercedes-Benz® 3500 chassis with 170 in. wheelbase
- V-6 Turbo 188 HP diesel engine with electronic fuel injection and 325 ft.-lb. torque
- One-piece, seamless, fiberglass front cap with automotive-bonded, panoramic window and power shade
- One-piece, seamless, fiberglass roof
- 15,000 BTU low-profile A/C
- Girard® armless patio awning with LED light strip
- Aluminum skirt-hung baggage doors
- Backup camera
- 10.25 in. integrated Mercedes-Benz® infotainment center with GPS
- Ultraleather® swivel driver and passenger seats
- Tecnoform® high-gloss cabinetry
- High-gloss hardwood fascia
- Custom-molded ABS surround in cab-over area
- 6 cu. ft. gas/electric/12V refrigerator
- Truma Aqua-Go® Comfort Plus tankless water heater
- Standard full-body paint

HUDSON



DAWN FULL-BODY PAINT



DUSK FULL-BODY PAINT



TWILIGHT FULL-BODY PAINT

Scan QR code to view Melbourne Prestige on web



SPECS

Follow Jayco
#LetsJayco



MODEL	FLOORPLAN	EXTERIOR LENGTH	EXTERIOR WIDTH	EXTERIOR HEIGHT (WITH A/C)	INTERIOR HEIGHT	WHEEL BASE	FRESH WATER CAPACITY (GAL.)	GRAY WASTE WATER CAPACITY (GAL.)	BLACK WASTE WATER CAPACITY (GAL.)
MELBOURNE	24K	25' 2"	96"	11' 5"	83"	170"	43	31	31
	24L	25' 2"	96"	11' 5"	83"	170"	43	31	31
	24T	25' 2"	96"	11' 5"	83"	170"	43	31	31
MELBOURNE PRESTIGE	24KP	25' 2"	96"	10' 11"	80"	170"	43	31	31
	24LP	25' 2"	96"	10' 11"	80"	170"	43	31	31
	24RP	25' 2"	96"	10' 11"	80"	170"	43	31	31
	24TP	25' 2"	96"	10' 11"	80"	170"	43	31	31



Scan QR code for specification definitions



Scan QR code for more information

THE JAYCO DIFFERENCE

1. **One-piece seamless fiberglass front cap** for increased durability and protection
2. **750 lb. overhead bunk capacity** offers nearly 250 lbs. more than the industry average for greater safety and peace of mind
3. **Integrated electric step** maximizes ground clearance and floor space
4. **Integrated third brake light** improves safety on the road
5. **Stronghold VBL™** vacuum-bonded, laminated floor, sidewalls and roof
6. **Frameless windows** make exterior maintenance easier than ever and give the unit a sleek, modern look

FREE
ROADSIDE ASSISTANCE

 **Coach-Net** A year's access to Coach-Net™—the country's largest RV emergency road service.

From the sales experience to service after the sale, we consider our dealers to be an important part of the Jayco family. Establishing a solid relationship with your local Jayco dealer is a key component in the enjoyment of your new Jayco. By purchasing from a local dealer, you will have a convenient location for sales, parts and service support. We hope you consider them a part of your camping family.

Meet your Jayco Dealer _____

2+3
YEAR | YEAR
WARRANTY

TRAVEL WITH CONFIDENCE • NO ONE OFFERS A BETTER WARRANTY

At Jayco, we build our RVs to handle every adventure, then back them with our industry-leading 2+3 limited warranty. Our 2-year limited warranty has you covered for 2 camping seasons. That's 730 days. In addition, our 3-year structural limited warranty has you covered for 3 camping seasons or 1,095 days. You won't find a better limited warranty in the business, because the only strings that we attach are those that deliver the ultimate in reliability. That's the Jayco difference. So go explore. For a copy of our 2-year limited + 3-year structural limited warranty with complete terms and conditions, please contact your local Jayco dealer.

**LAMESA REC
VAN**

Generations of family fun.

Jayco, Inc. | P.O. Box 460 | Middlebury, IN 46540 

See dealer for further information and prices. All information in this brochure and on www.jayco.com is the latest available at the time of publication approval. Jayco reserves the right to make changes and to discontinue models without notice or obligation. Photography may show optional equipment or props used for decoration purposes only. RVs built for sale in Canada may differ to conform to Canadian codes. JAYCO and the JAYCO BIRD IN FLIGHT are registered trademarks of Jayco, Inc. Printed in USA 10/20 ©2020 Jayco, Inc.

LaMesaRV.com
800-496-8778